



Cassarya

C A B I N E T R Y

Where Craftsmanship Meets
the Art of Fine Living



LA DOLCE VITA

In Italian it's known as *the good life*—the life you deserve. At Cassarya, we know that a beautiful life starts with your living space. Our team has travelled around the world to bring you best-in-class quality and styles. As artisans of the home, we focus on the fine details to add comfort and charm to your everyday.

The Cassarya promise:

Expedited Shipping

We ship in less than half of the industry's standard lead-time.

Limited Lifetime Warranty

Quality and durability are guaranteed. We make our products to last.

Quality and Value

Cassarya can be defined by *qualita e valore*: quality and value. You will not find this level of specification and value from any other brand.

Exceptional Service

Our friendly, expert team knows our kitchens inside and out. We're here to help every step of the way.

Professional Design Services

Our in-house team provides detailed design services for all of your project needs.

Your journey to *La Dolce Vita* begins here.

Email info@cassarya.com or call **1-877-726-7272**

FREE DESIGN



READY WITHIN
48-HOURS



FREE DESIGN SERVICE

We offer custom room layout designs, ready within 48 hours!

Contact us for details at info@cassarya.com.



Palermo Collection

Palermo is known for its architecture, history, and culinary traditions, providing a familiar comfort with a bit of modern luxury. It's only fitting that our Palermo collection does the same with its soothing and sophisticated style.

- *Light gray v-groove shaker*
- *Silky paint-like laminated finish*







Amalfi Collection

Classic, versatile, and comforting. We've always been fond of how the Amalfi Coast intersects the beauty of nature with the practicality of living. We've brought that perfect mix to you in the form of this timeless style.

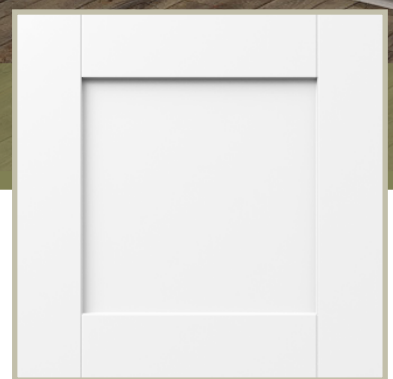

- *Bright white v-groove shaker*
- *Silky paint-like laminated finish*



Marsala Collection

A rich marsala wine can enhance any mood—just like our Marsala collection. Whether it's the scene for your culinary adventures or a meeting space for your loved ones, the smooth lines of Marsala will add a soothing backdrop to your moments and memories.

- *Bright white slab profile*
- *Silky paint-like laminated finish*







Naples Collection

Spending a day in Naples can feel like travelling back in time. The buildings carry a historic reverence for beauty not seen often in modern times. With our Naples collection, the soft grey tones of ancient marble journey to your home, imparting a touch of romance.



- *Light gray recessed panel*
- *Premium high-quality painted finish*



Sassari Collection

Known for its local artisans, Sassari is where you'll find your perfect Italian souvenir. The bold finish and texture of our Sassari collection is inspired by these contemporary craftsmen.

- *Burnt walnut slab profile*
- *Vertical grain laminated finish*









Barletta Collection



Like its namesake on the Adriatic sea, our Barletta collection conjures up a warm summer evening by the water. Natural, cozy, and rich, it's a sumptuous indulgence for your senses.

- *Warm white wide-rail shaker*
- *Premium high-quality painted finish*



Veneto Collection



As you weave your way through the streets and canals of Venice, you experience a sense of wonder and awe. We've brought that same spirit to our Veneto collection with its rich, striking color and distinct style.

- *Slate gray wide-rail shaker*
- *Premium high-quality painted finish*









Rivoli Collection

The city of Rivoli welcomes you with its medieval charm. Our collection's transitional style blends modern elements with traditional detail for a touch of that historic allure.



- *Bright white recessed cove*
- *Premium high-quality painted finish*



Milazzo Collection

Milazzo is a city fueled by water. From ancient Roman tales to the ocean sports of today, the sea is its centerpiece. We've brought Milazzo to your home with the deep blue paneling of our transitional design, turning your day-to-day into a permanent vacation.

- *Midnight blue recessed cove*
- *Premium high-quality painted finish*





Amalfi

CABINETS FOR THE WHOLE HOME

It's easy to combine Cassarya cabinets to create functional and beautiful storage for your whole home: the mudroom, entertaining spaces, office, laundry room, bathroom, and more!



Naples

CABINET FEATURES

With Cassarya cabinetry, superior construction, soft-close doors and drawers, and durable premium-painted finishes are all standard.



1 Full-access frameless design removes face frame, offering a streamlined look and additional storage space.

2 Soft-close extra wide drawers.

3 Soft-close, slim-line metal drawer boxes with full-extension undermount glides.

4 Designer neutral linen pattern interior lends an upscale look, is easy-to-clean, and is stain- and moisture-resistant.

5 Heavy storage capacity with 3/4-inch full-depth shelves.

6 Strength and durability with 5/8 inch side gables.

7 Soft-close tool-free press-in hinges are easy to install and adjustable.

8 Adjustable legs allow easy leveling, minimize water damage, and create smooth gliding across floors.



Quality and durability guaranteed—our collections are made to last.

FINISHING TOUCHES

Add stylish finishing touches to your project with our choice of color-matched panels and trims, designed to complete your kitchen beautifully. Our cover panels and fillers are finished on both sides and all four edges.

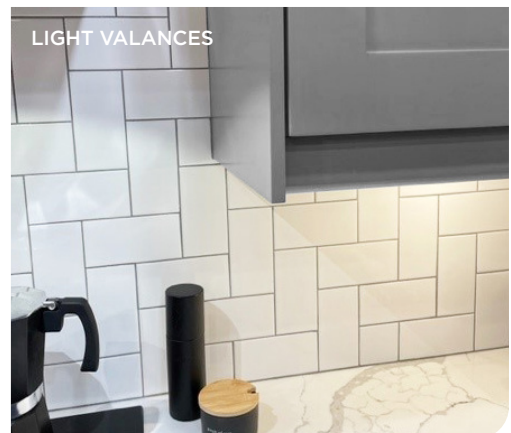
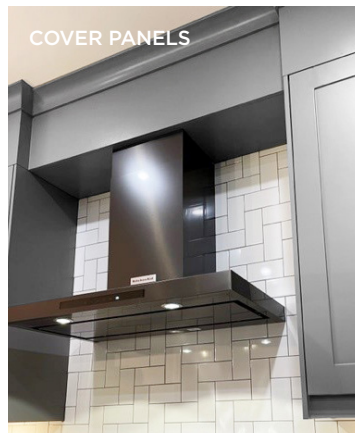

STORAGE ACCESSORIES

Everything in its place. Our selection of storage accessories maximizes space, creating the organized kitchen you've always wanted!

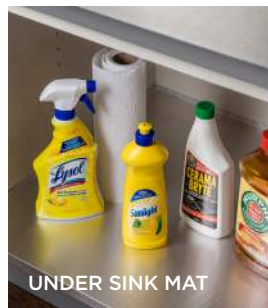

DOOR & DRAWER SIZES

Our quality-constructed doors use only premium materials enhanced with stunning, chic finishes. Guaranteed to be enjoyed for years to come.

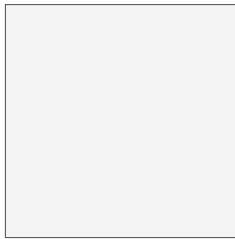

MARSALA



SASSARI



PALERMO

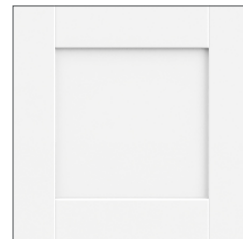

AMALFI

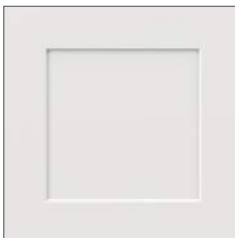

BARLETTA



VENETO

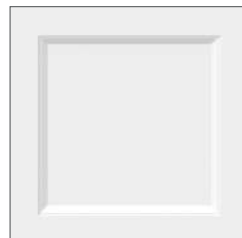

RIVOLI



MILAZZO

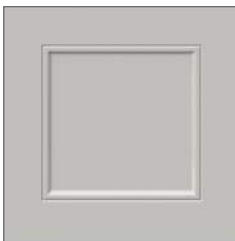

NAPLES

DOOR FRONTS (WxDxH)

13 1/2 x 3/4 x 10"	12 x 3/4 x 25"	9 x 3/4 x 35"
15 x 3/4 x 10"	13 1/2 x 3/4 x 25"	12 x 3/4 x 35"
16 1/2 x 3/4 x 10"	15 x 3/4 x 25"	13 1/8 x 3/4 x 35"
18 x 3/4 x 10"	16 1/2 x 3/4 x 25"	13 1/2 x 3/4 x 35"
13 1/2 x 3/4 x 15"	18 x 3/4 x 25"	15 x 3/4 x 35"
15 x 3/4 x 15"	21 x 3/4 x 25"	16 1/2 x 3/4 x 35"
16 1/2 x 3/4 x 15"	24 x 3/4 x 25"	18 x 3/4 x 35"
18 x 3/4 x 15"	9 x 3/4 x 30"	21 x 3/4 x 35"
12 x 3/4 x 20"	11 x 3/4 x 30"	24 x 3/4 x 35"
13 1/2 x 3/4 x 20"	12 x 3/4 x 30"	
15 x 3/4 x 20"	13 1/8 x 3/4 x 30"	
16 1/2 x 3/4 x 20"	13 1/2 x 3/4 x 30"	
18 x 3/4 x 20"	15 x 3/4 x 30"	
21 x 3/4 x 20"	16 1/2 x 3/4 x 30"	
24 x 3/4 x 20"	18 x 3/4 x 30"	
	21 x 3/4 x 30"	
	24 x 3/4 x 30"	

DRAWER FRONTS (WxDxH)

12 x 3/4 x 5"	12 x 3/4 x 15"
15 x 3/4 x 5"	15 x 3/4 x 15"
18 x 3/4 x 5"	18 x 3/4 x 15"
21 x 3/4 x 5"	21 x 3/4 x 15"
24 x 3/4 x 5"	24 x 3/4 x 15"
27 x 3/4 x 5"	27 x 3/4 x 15"
30 x 3/4 x 5"	30 x 3/4 x 15"
33 x 3/4 x 5"	33 x 3/4 x 15"
36 x 3/4 x 5"	36 x 3/4 x 15"
12 x 3/4 x 10"	
15 x 3/4 x 10"	
18 x 3/4 x 10"	
21 x 3/4 x 10"	
24 x 3/4 x 10"	
27 x 3/4 x 10"	
30 x 3/4 x 10"	
33 x 3/4 x 10"	
36 x 3/4 x 10"	

GLASS DOOR FRONTS (WxDxH)

13 1/8 x 3/4 x 30"
13 1/8 x 3/4 x 35"
15 x 3/4 x 30"
15 x 3/4 x 35"
18 x 3/4 x 30"
18 x 3/4 x 35"

Glass Door Options

- Select size matching glass doors available
- All glass doors include clear tempered glass with matching frames
- Marsala glass doors will have an Amalfi style frame
- Not available for Sassari

CABINETS & ACCESSORIES

Choose from our extensive collection of base, wall, and tall cabinets, plus accessories available in all the shapes and sizes you need.

BASE CABINETS

Cabinets are 34 1/2" high including legs x 24" deep. Width options are listed with each cabinet.

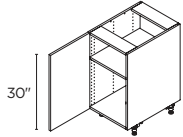

1 DOOR
 9" | B9FH(L/R)
 12" | B12FH(L/R)
 15" | B15FH(L/R)
 18" | B18FH(L/R)
 21" | B21FH(L/R)
 24" | B24FH(L/R)

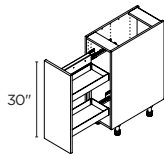

BASE SINGLE DOOR AND PULL-OUT SPICE RACK
 9" | B9FHPOL
 9" | B9FHPOR
 12" | B12FHPOL
 12" | B12FHPOR

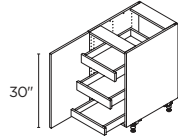

1 DOOR
3 INNER DRAWERS
 15" | B15FHI3(L/R)
 18" | B18FHI3(L/R)
 21" | B21FHI3(L/R)
 24" | B24FHI3(L/R)

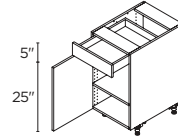

1 DOOR
1 DRAWER
 12" | B12(L/R)
 15" | B15(L/R)
 18" | B18(L/R)
 21" | B21(L/R)
 24" | B24(L/R)

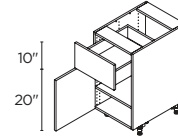

1 DOOR
1 DRAWER
 12" | B12A(L/R)
 15" | B15A(L/R)
 18" | B18A(L/R)
 21" | B21A(L/R)
 24" | B24A(L/R)

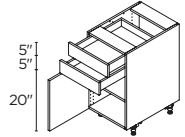

1 DOOR
2 DRAWERS
 12" | B12B(L/R)
 15" | B15B(L/R)
 18" | B18B(L/R)
 21" | B21B(L/R)
 24" | B24B(L/R)

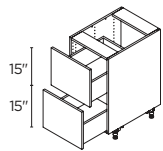

2 DRAWERS
 12" | B2D12
 15" | B2D15
 18" | B2D18
 21" | B2D21
 24" | B2D24 27" | B2D27
 30" | B2D30
 33" | B2D33
 36" | B2D36

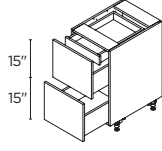

2 DRAWERS
1 INNER DRAWER
 12" | B2D12I1
 15" | B2D15I1
 18" | B2D18I1
 21" | B2D21I1
 24" | B2D24I1
 27" | B2D27I1
 30" | B2D30I1
 33" | B2D33I1
 36" | B2D36I1

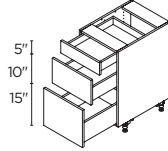

3 DRAWERS
 12" | B3D12
 15" | B3D15
 18" | B3D18
 21" | B3D21
 24" | B3D24
 27" | B3D27
 30" | B3D30
 33" | B3D33
 36" | B3D36

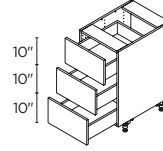

3 DRAWERS
 12" | B3DA12
 15" | B3DA15
 18" | B3DA18
 21" | B3DA21
 24" | B3DA24
 27" | B3DA27
 30" | B3DA30
 33" | B3DA33
 36" | B3DA36

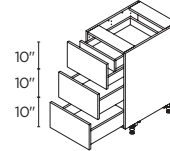

3 DRAWERS
1 INNER DRAWER
 12" | B3DA12I1
 15" | B3DA15I1
 18" | B3DA18I1
 21" | B3DA21I1
 24" | B3DA24I1
 27" | B3DA27I1
 30" | B3DA30I1
 33" | B3DA33I1
 36" | B3DA36I1

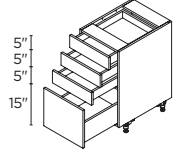

4 DRAWERS
 12" | B4D12
 15" | B4D15
 18" | B4D18
 21" | B4D21
 24" | B4D24
 27" | B4D27
 30" | B4D30
 33" | B4D33
 36" | B4D36

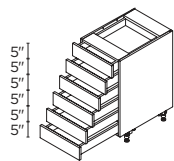

6 DRAWERS
 12" | B6D12
 15" | B6D15
 18" | B6D18
 21" | B6D21
 24" | B6D24
 27" | B6D27
 30" | B6D30
 33" | B6D33
 36" | B6D36

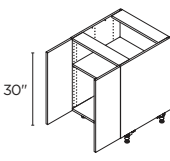

2 DOORS
 24" | B24-2FH
 27" | B27FH
 30" | B30FH
 33" | B33FH
 36" | B36FH

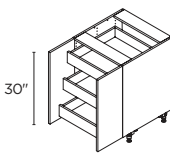

2 DOORS
3 INNER DRAWERS
 24" | B24-2FHI3
 27" | B27FHI3
 30" | B30FHI3
 33" | B33FHI3
 36" | B36FHI3

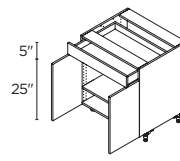

2 DOORS
1 DRAWER
 27" | B27
 30" | B30
 33" | B33
 36" | B36

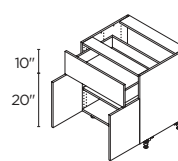

2 DOORS /
1 DRAWER
 | B27A
 | B30A
 | B33A
 | B36A

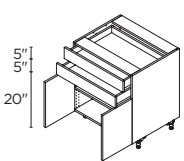

2 DOORS /
2 DRAWERS
 27" | B27B
 30" | B30B
 33" | B33B
 36" | B36B

CORNER CABINETS

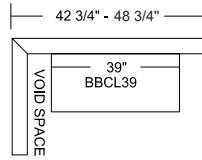
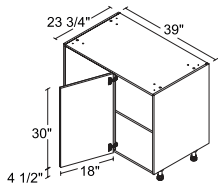

BLIND CORNER WITH SHELF

39" | BBCL39
39" | BBCR39

Min. 42 3/4" doesn't allow for filler / hardware clearance.

Max. 48 3/4" is with 6" filler attached to be flush with door - filler not included.

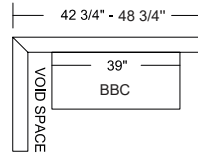
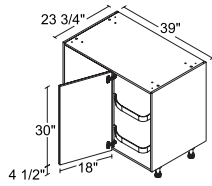

BLIND CORNER WITH LEMANS PULL-OUT

39" | BBCL39LC
39" | BBCR39LC

Min. 42 3/4" doesn't allow for filler / hardware clearance.

Max. 48 3/4" is with 6" filler attached to be flush with door - filler not included.

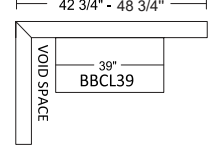
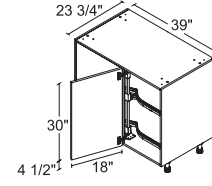

BLIND CORNER WITH PREMIUM LEMANS

39" | BBCL39LCP
39" | BBCR39LCP

Min. 42 3/4" doesn't allow for filler / hardware clearance.

Max. 48 3/4" is with 6" filler attached to be flush with door - filler not included.

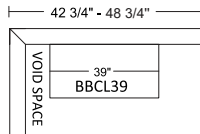
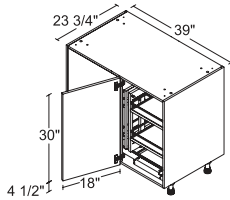

BLIND CORNER WITH MAGIC CORNER PULL-OUT

39" | BBCL39MCP
39" | BBCR39MCP

Min. 42 3/4" doesn't allow for filler / hardware clearance.

Max. 48 3/4" is with 6" filler attached to be flush with door - filler not included.

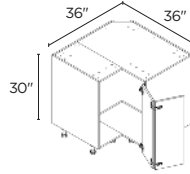

CORNER WITH SHELF

36" | BC36(L/R)

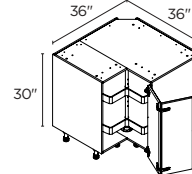

CORNER WITH LAZY SUSAN

36" | BC36LS(L/R)

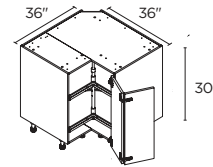

CORNER WITH PREMIUM LAZY SUSAN

36" | BC36LSP(L/R)

SINK CABINETS

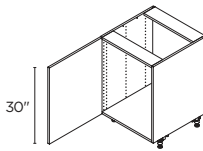

1 DOOR
24" | SB24FH(L/R)

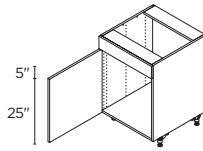

1 DOOR /
1 FIXED FRONT
24" | SB24FF(L/R)

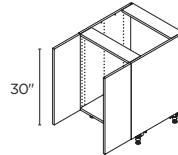

2 DOORS
24" | SB24-2FH
27" | SB27FH
30" | SB30FH
33" | SB33FH
36" | SB36FH

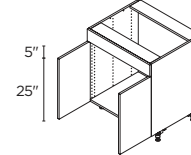

2 DOORS /
1 FIXED FRONT
27" | SB27FF
30" | SB30FF
33" | SB33FF
36" | SB36FF

FARM SINK CABINETS

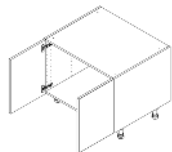

30" | SBAS30
36" | SBAS36

A separate drawer front must be ordered to complete.

MICROWAVE CABINET

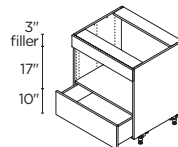

1 DRAWER
30" | BMW30

Cut-out size: 28 1/2" wide x 17" high.
Filler can be cut to adjust height opening 17" to 20".

BASE WINDOW SEATS

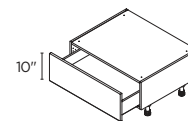

1 DRAWER
30" | BWS3010
36" | BWS3610

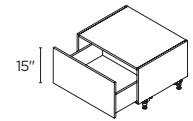

1 DRAWER
30" | BWS3015
36" | BWS3615

BASE CABINETS

Cabinets are 34 1/2" high including legs x 24" deep. Width options are listed with each cabinet.

COOKTOP CABINETS

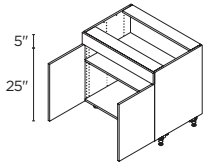

**2 DOORS /
1 FIXED FRONT**
36" | BCT36FF

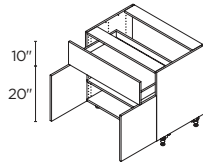

**2 DOORS /
1 DRAWER**
36" | BCT36A

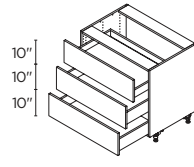

3 DRAWERS
36" | BCT3D36A

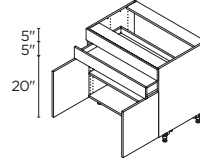

**2 DOORS /
1 DRAWER /
1 FIXED FRONT**
36" | BCT36BFF

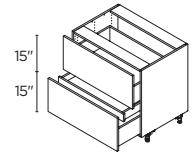

**2 DRAWERS /
1 INNER DRAWER**
36" | BCT2D36I

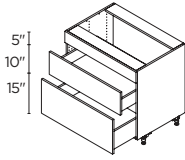

**2 DRAWERS /
1 FIXED FRONT**
36" | BCT3D36FF

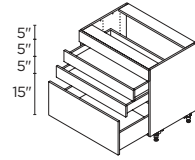

**3 DRAWERS /
1 FIXED FRONT**
36" | BCT4D36FF

WASTE/RECYCLE CABINETS

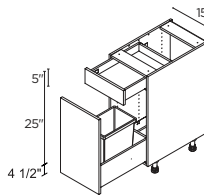

PULL-OUT / 1 DRAWER
15" | BP015
Comes with 1 bin

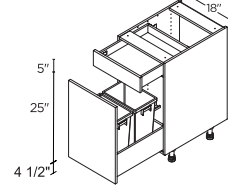

PULL-OUT / 1 DRAWER
18" | BP018
Comes with 2 bins

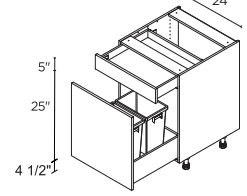

PULL-OUT / 1 DRAWER
24" | BP024
Comes with 2 bins

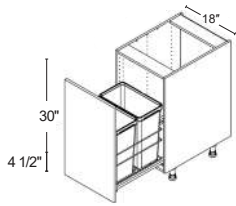

FULL HEIGHT DOOR
18" | B18FHSWB
Comes with 2 bins

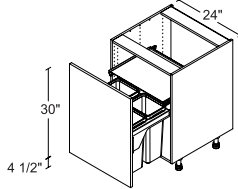

FULL HEIGHT DOOR
24" | B24FHSWB
Comes with 3 bins

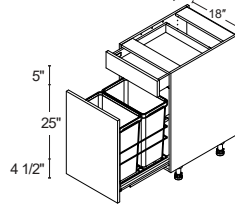

PULL-OUT / 1 DRAWER
18" | B18SWB
Comes with 2 bins

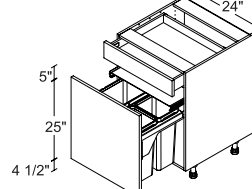

PULL-OUT / 1 DRAWER
24" | B24SWB
Comes with 3 bins

Bins can be ordered separately in the accessory section.

SHALLOW BASE CABINETS

Cabinets are 34 1/2" high including legs x 14" deep. Width options are listed with each cabinet.

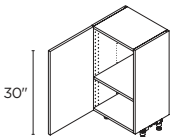

1 DOOR
9" | B914FH(L/R)
12" | B1214FH(L/R)
15" | B1514FH(L/R)
18" | B1814FH(L/R)
21" | B2114FH(L/R)
24" | B2414FH(L/R)

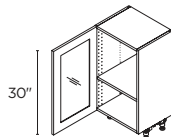

1 GLASS DOOR*
15" | BG1514FH(L/R)
18" | BG1814FH(L/R)

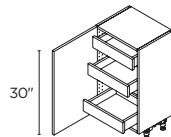

1 DOOR / 3 INNER DRAWERS
15" | B1514FHI3(L/R)
18" | B1814FHI3(L/R)
24" | B2414FHI3(L/R)

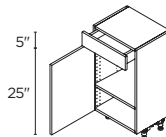

1 DOOR / 1 DRAWER
15" | B1514(L/R)
18" | B1814(L/R)
24" | B2414(L/R)

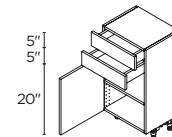

1 DOOR / 2 DRAWERS
15" | B1514B(L/R)
18" | B1814B(L/R)
24" | B2414B(L/R)

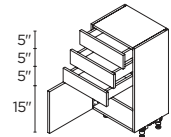

1 DOOR / 3 DRAWERS
15" | B1514C(L/R)
18" | B1814C(L/R)

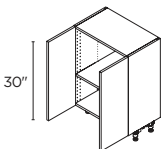

2 DOORS
24" | B2414-2FH
27" | B2714FH
30" | B3014FH
33" | B3314FH
36" | B3614FH

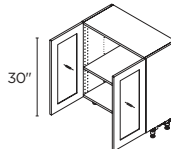

2 GLASS DOORS*
30" | BG3014FH
36" | BG3614FH

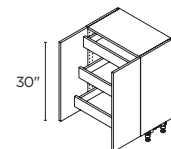

2 DOORS / 3 INNER DRAWERS
24" | B2414-2FHI3

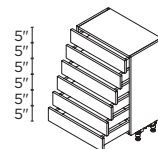

6 DRAWERS
15" | B6D1514
18" | B6D1814
24" | B6D2414

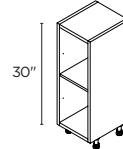

BASE OPEN SHELF
9" | B0S930

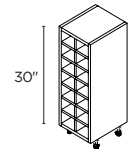

BASE WINE RACK
9" | BWR930

**Glass shelves can be purchased separately.*

WALL CABINETS

Our wall and glass door wall cabinets are 14" deep while our deep and corner wall cabinets are 24" deep. Height and width options are listed with each cabinet.

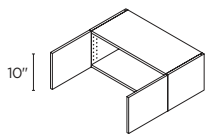

**10" HIGH
2 DOORS**

27" | W2710
30" | W3010
33" | W3310
36" | W3610

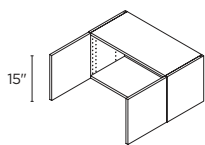

**15" HIGH
2 DOORS**

27" | W2715
30" | W3015
33" | W3315
36" | W3615

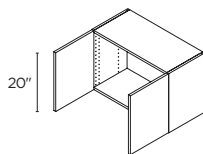

**20" HIGH
2 DOORS**

24" | W2420-2
27" | W2720
30" | W3020
33" | W3320
36" | W3620

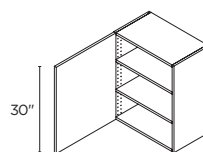

**30" HIGH
1 DOOR**

9" | W930(L/R)
12" | W1230(L/R)
15" | W1530(L/R)
18" | W1830(L/R)
21" | W2130(L/R)
24" | W2430(L/R)

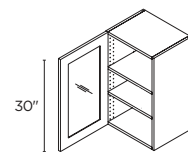

**30" HIGH
1 GLASS DOOR***

15" | WG1530(L/R)
18" | WG1830(L/R)

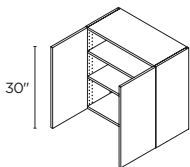

**30" HIGH
2 DOORS**

24" | W2430-2
27" | W2730
30" | W3030
33" | W3330
36" | W3630

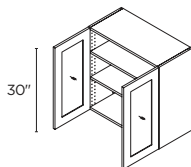

**30" HIGH
2 GLASS DOORS***

30" | WG3030
36" | WG3630

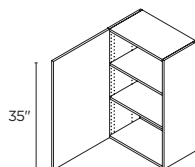

**35" HIGH
1 DOOR**

9" | W935(L/R)
12" | W1235(L/R)
15" | W1535(L/R)
18" | W1835(L/R)
21" | W2135(L/R)
24" | W2435(L/R)

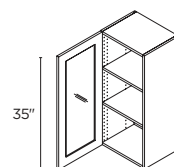

**35" HIGH
1 GLASS DOOR***

15" | WG1535(L/R)
18" | WG1835(L/R)

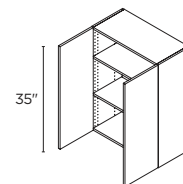

**35" HIGH
2 DOORS**

24" | W2435-2
27" | W2735
30" | W3035
33" | W3335
36" | W3635

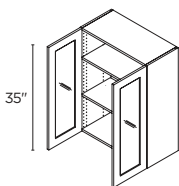

**35" HIGH
2 GLASS DOORS***

30" | WG3035
36" | WG3635

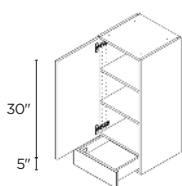

**35" HIGH
1 DOOR / 1 DRAWER**

15" | W1535A(L/R)
18" | W1835A(L/R)
24" | W2435A(L/R)

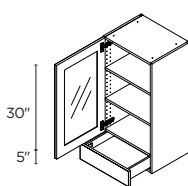

**35" HIGH
1 GLASS DOOR* / 1 DRAWER**

15" | WG1535A(L/R)
18" | WG1835A(L/R)

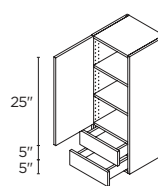

**35" HIGH
1 DOOR / 2 DRAWERS**

15" | W1535B(L/R)
18" | W1835B(L/R)
24" | W2435B(L/R)

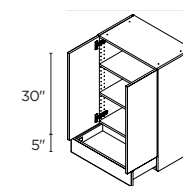

**35" HIGH
2 DOORS /
1 DRAWER**

24" | W2435-2A

LIFT-UP WALL CABINETS

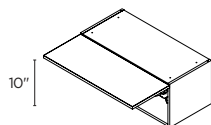

**10" HIGH
1 LIFT-UP DOOR**

24" | WLU2410
27" | WLU2710
30" | WLU3010
33" | WLU3310
36" | WLU3610

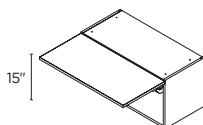

**15" HIGH
1 LIFT-UP DOOR**

24" | WLU2415
27" | WLU2715
30" | WLU3015
33" | WLU3315
36" | WLU3615

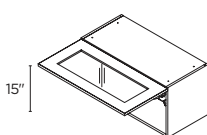

**15" HIGH
1 GLASS LIFT-UP
DOOR**

30" | WLUG3015

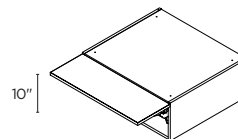

**10" HIGH
1 LIFT-UP DOOR**

24" | WLU241024
27" | WLU271024
30" | WLU301024
33" | WLU331024
36" | WLU361024

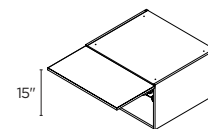

**15" HIGH
1 LIFT-UP DOOR**

24" | WLU241524
27" | WLU271524
30" | WLU301524
33" | WLU331524
36" | WLU361524

*Glass shelves can be purchased separately.

WALL CABINETS

Our wall and glass door wall cabinets are 14" deep while our deep and corner wall cabinets are 24" deep. Height and width options are listed with each cabinet.

DEEP WALL CABINETS

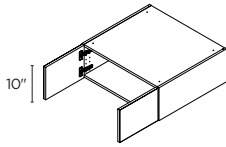

**10" HIGH
2 DOORS**

- 27" | W271024
- 30" | W301024
- 33" | W331024
- 36" | W361024

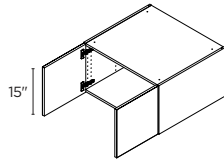

**15" HIGH
2 DOORS**

- 27" | W271524
- 30" | W301524
- 33" | W331524
- 36" | W361524

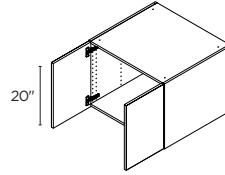

**20" HIGH
2 DOORS**

- 24" | W242024-2
- 27" | W272024
- 30" | W302024
- 33" | W332024
- 36" | W362024

WALL MICROWAVE SHELF

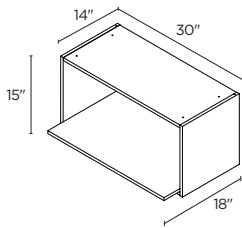

**15" HIGH
30" | WMS3015**

*Finished interior shelf is removable.

SPECIALTY WALL CABINETS

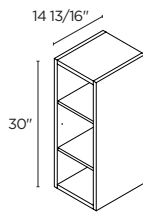

**WALL OPEN
SHELF
9" | WOS930**

*Vertical or horizontal installation

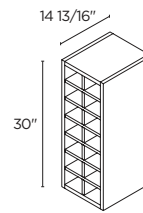

**WALL WINE
RACK
9" | WWC930**

CORNER WALL CABINETS

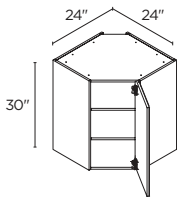

**30" HIGH
1 DOOR
24" | WA2430(L/R)**

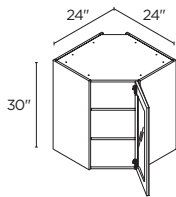

**30" HIGH
1 GLASS DOOR*
24" | WAG2430(L/R)**

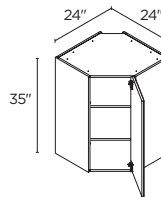

**35" HIGH
1 DOOR
24" | WA2435(L/R)**

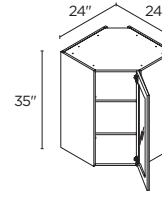

**35" HIGH
1 GLASS DOOR*
24" | WAG2435(L/R)**

BLIND CORNER WALL CABINETS

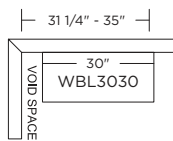
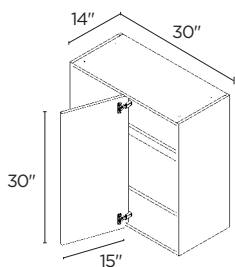

**30" HIGH
1 DOOR
30" | WBL3030
30" | WBR3030**

Max. 35" is with 6" filler attached to be flush with door - filler not included.

Panel next to door is white for all collections. Filler is required.

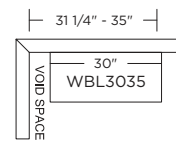
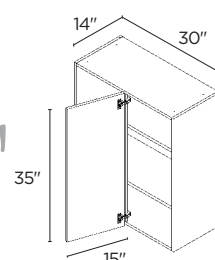

**35" HIGH
1 DOOR
35" | WBL3035
35" | WBR3035**

*Glass shelves can be purchased separately.

84 1/2" H TALL CABINETS

These cabinets are 24" deep x 84 1/2" high. Width options are listed with each cabinet.

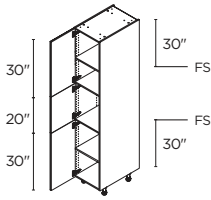

3 DOORS
15" | T152484.5(L/R)
18" | T182484.5(L/R)
24" | T242484.5(L/R)

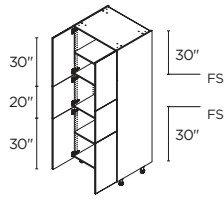

6 DOORS
30" | T302484.5

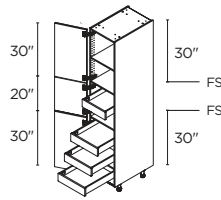

3 DOORS / 4 INNER DRAWERS
15" | T152484.5I4(L/R)
18" | T182484.5I4(L/R)
24" | T242484.5I4(L/R)

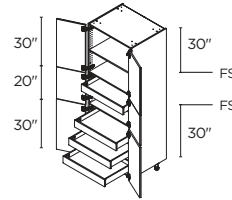

6 DOORS / 4 INNER DRAWERS
30" | T302484.5I4

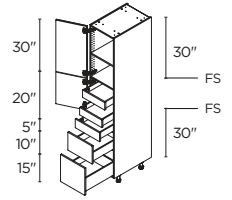

2 DOORS / 3 DRAWERS / 2 INNER DRAWERS
15" | T3D152484.5I2(L/R)
18" | T3D182484.5I2(L/R)
24" | T3D242484.5I2(L/R)

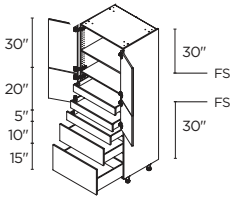

4 DOORS / 3 DRAWERS / 2 INNER DRAWERS
30" | T3D302484.5I2

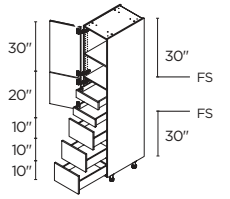

2 DOORS / 3 DRAWERS / 2 INNER DRAWERS
15" | T3DA152484.5I2(L/R)
18" | T3DA182484.5I2(L/R)
24" | T3DA242484.5I2(L/R)

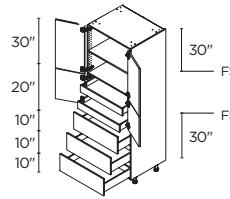

4 DOORS / 3 DRAWERS / 2 INNER DRAWERS
30" | T3DA302484.5I2

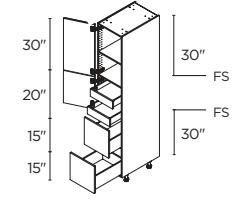

2 DOORS / 2 DRAWERS / 2 INNER DRAWERS
15" | T2D152484.5I2(L/R)
18" | T2D182484.5I2(L/R)
24" | T2D242484.5I2(L/R)

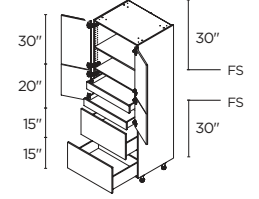

4 DOORS / 2 DRAWERS / 2 INNER DRAWERS
30" | T2D302484.5I2

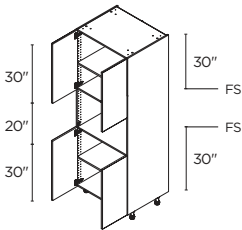

MICROWAVE¹
4 DOORS
30" | TM3084.5

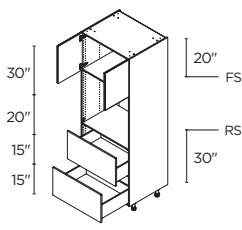

MICROWAVE¹
2 DOORS / 2 DRAWERS
30" | TM2D3084.5

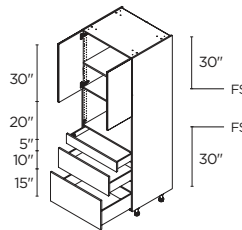

MICROWAVE¹
2 DOORS / 3 DRAWERS
30" | TM3D3084.5

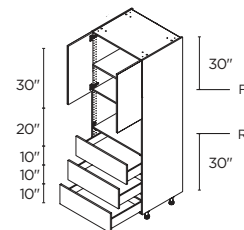

MICROWAVE¹
2 DOORS / 3 DRAWERS
30" | TM3DA3084.5

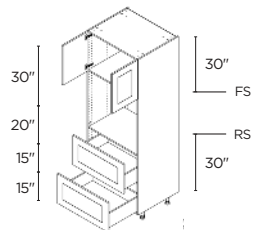

MICROWAVE¹
2 DOORS / 2 DRAWERS
30" | T02D3084.5

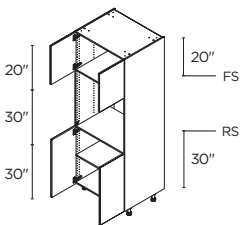

SINGLE OVEN⁴
4 DOORS
30" | T03084.5

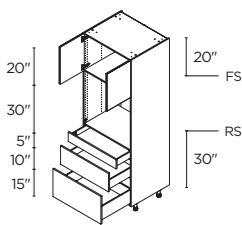

SINGLE OVEN⁴
2 DOORS / 3 DRAWERS
30" | T03D3084.5

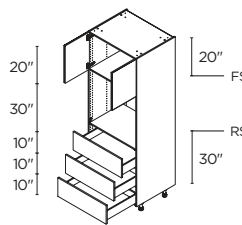

SINGLE OVEN⁴
2 DOORS / 3 DRAWERS
30" | T03DA3084.5

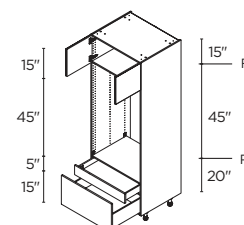

MICRO/WALL OVEN²
2 DOORS / 2 DRAWERS
30" | TM02D3084.5

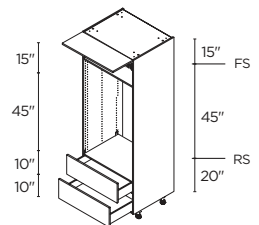

MICRO/WALL OVEN²
1 LIFT-UP DOOR / 2 DRAWERS
30" | TM0L2DA3084.5

RS = Reinforced Shelf. FS = Fixed Shelf. **Appliance cut-out sizes:** (use of a filler is required and must be ordered separately): ¹28 1/2" width x 18 1/2" high. ²28 1/2" width x 43 1/2" high. ³28 1/2" width x 53 1/2" high. ⁴28 1/2" width x 28 1/2" high.

84 1/2" H TALL CABINETS

These cabinets are 24" deep x 84 1/2" high. Width options are listed with each cabinet.

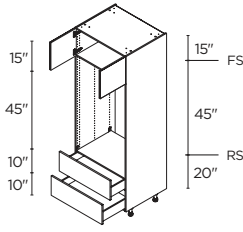

MICRO/WALL OVEN²
2 DOORS /
2 DRAWERS
30" | TM02DA3084.5

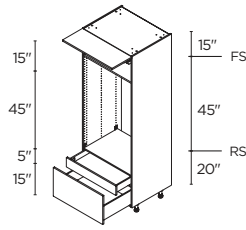

MICRO/WALL OVEN²
1 LIFT-UP DOOR /
2 DRAWERS
30" | TM0L2D3084.5

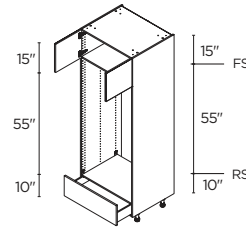

DOUBLE OVEN³
2 DOORS /
1 DRAWER
30" | TD0A3084.5

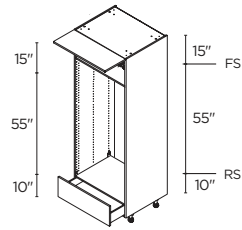

DOUBLE OVEN³
1 LIFT-UP DOOR /
1 DRAWER
30" | TD0LA3084.5

89 1/2" H TALL CABINETS

These cabinets are 24" deep x 89 1/2" high. Width options are listed with each cabinet.

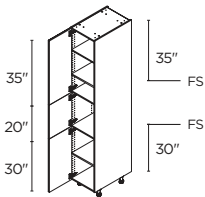

3 DOORS
15" | T152489.5(L/R)
18" | T182489.5(L/R)
24" | T242489.5(L/R)

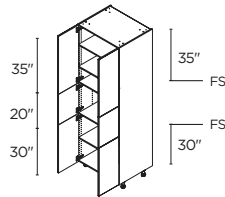

6 DOORS
30" | T302489.5

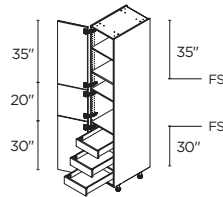

3 DOORS / 3 INNER DRAWERS
15" | T152489.5I3(L/R)
18" | T182489.5I3(L/R)
24" | T242489.5I3(L/R)

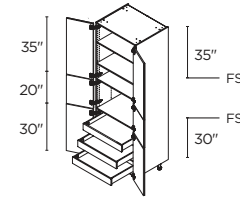

6 DOORS / 3 INNER DRAWERS
30" | T302489.5I3

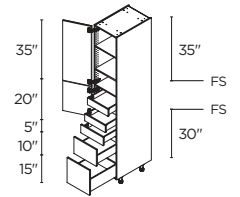

2 DOORS / 3 DRAWERS / 2 INNER DRAWERS
15" | T3D152489.5I2(L/R)
18" | T3D182489.5I2(L/R)
24" | T3D242489.5I2(L/R)

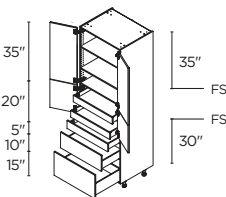

4 DOORS / 3 DRAWERS / 2 INNER DRAWERS
30" | T3D302489.5I2

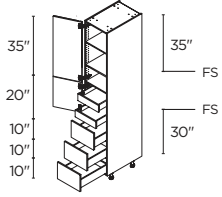

2 DOORS / 3 DRAWERS / 2 INNER DRAWERS
15" | T3DA152489.5I2(L/R)
18" | T3DA182489.5I2(L/R)
24" | T3DA242489.5I2(L/R)

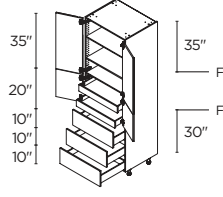

4 DOORS / 3 DRAWERS / 2 INNER DRAWERS
30" | T3DA302489.5I2

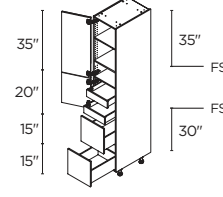

2 DOORS / 2 DRAWERS / 2 INNER DRAWERS
15" | T2D152489.5I2(L/R)
18" | T2D182489.5I2(L/R)
24" | T2D242489.5I2(L/R)

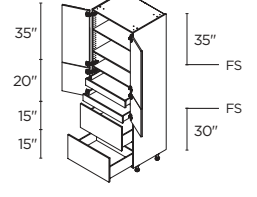

4 DOORS / 2 DRAWERS / 2 INNER DRAWERS
30" | T2D302489.5I2

89 1/2" H TALL APPLIANCE CABINETS

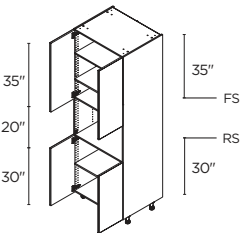

MICROWAVE¹
4 DOORS
30" | TM3089.5

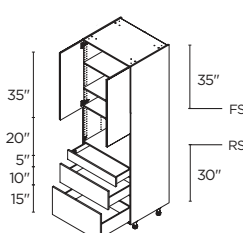

MICROWAVE¹
2 DOORS /
3 DRAWERS
30" | TM3D3089.5

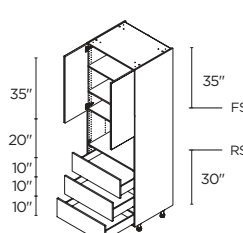

MICROWAVE¹
2 DOORS /
3 DRAWERS
30" | TM3DA3089.5

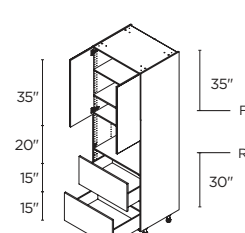

MICROWAVE¹
2 DOORS /
2 DRAWERS
30" | TM2D3089.5

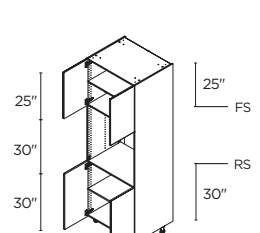

SINGLE OVEN³
4 DOORS
30" | T03089.5

RS = Reinforced Shelf. FS = Fixed Shelf. **Appliance cut-out sizes:** (use of a filler is required and must be ordered separately): ¹28 1/2" width x 18 1/2" high. ²28 1/2" width x 43 1/2" high. ³28 1/2" width x 53 1/2" high. ⁴28 1/2" width x 28 1/2" high.

89 1/2" H TALL APPLIANCE CABINETS

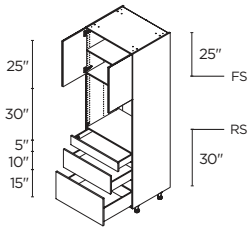

SINGLE OVEN³
2 DOORS / 3 DRAWERS
30" | T03D3089.5

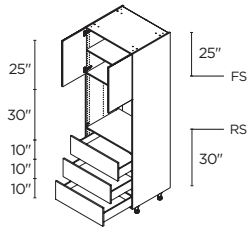

SINGLE OVEN³
2 DOORS / 3 DRAWERS
30" | T03DA3089.5

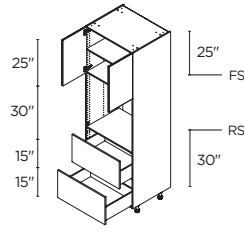

SINGLE OVEN³
2 DOORS / 2 DRAWERS
30" | T02D3089.5

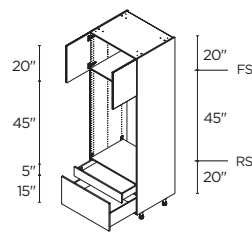

MICRO/WALL OVEN²
2 DOORS / 2 DRAWERS
30" | TM02D3089.5

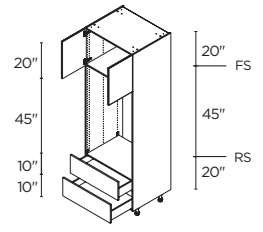

MICRO/WALL OVEN²
2 DOORS / 2 DRAWERS
30" | TM02DA3089.5

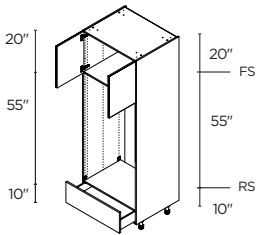

DOUBLE OVEN³
2 DOORS / 1 DRAWER
30" | TDOA3089.5

RS = Reinforced Shelf. FS = Fixed Shelf. **Appliance cut-out sizes:** (use of a filler is required and must be ordered separately): ¹ 28 1/2" width x 18 1/2" high. ² 28 1/2" width x 43 1/2" high. ³ 28 1/2" width x 53 1/2" high. ⁴ 28 1/2" width x 28 1/2" high.

VANITY CABINETS

STANDARD VANITIES *Produced with white interiors.*

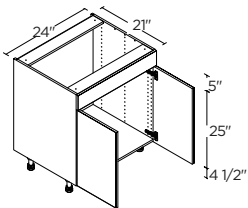

2 DOORS
24" | VS24

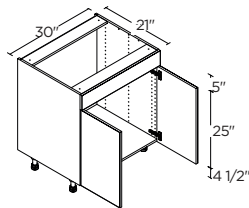

2 DOORS
30" | VS30

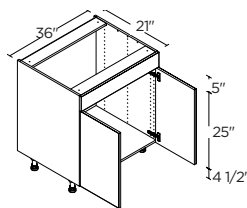

2 DOORS
36" | VS36

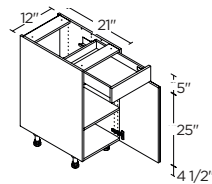

1 DOOR / 1 DRAWER
12" | V12(L/R)

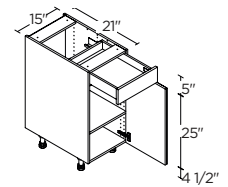

1 DOOR / 1 DRAWER
15" | V15(L/R)

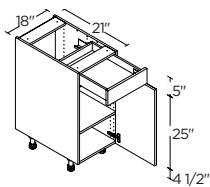

1 DOOR / 1 DRAWER
18" | V18(L/R)

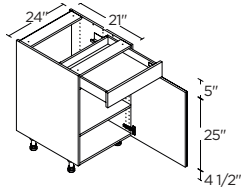

1 DOOR / 1 DRAWER
24" | V24(L/R)

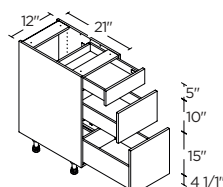

3 DRAWERS
12" | V3D12

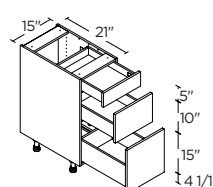

3 DRAWERS
15" | V3D15

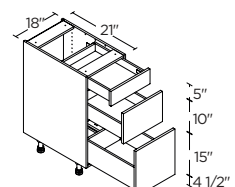

3 DRAWERS
18" | V3D18

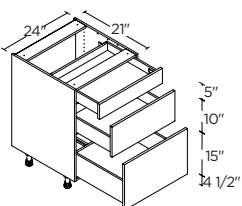

3 DRAWERS
24" | V3D24

UNIVERSAL CABINETS

UNIVERSAL KITCHEN CABINETS *Produced with white interiors.*

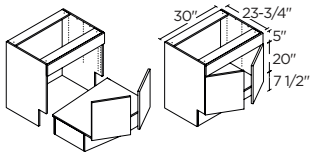

2 DOORS
30" | SB30FFRFADA

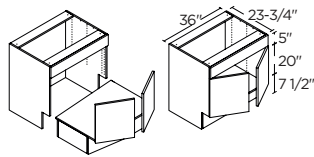

2 DOORS
36" | SB36FFRFADA

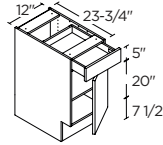

1 DOOR / 1 DRAWER
12" | B12ADA

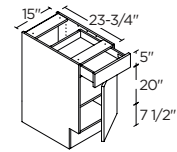

1 DOOR / 1 DRAWER
15" | B15ADA

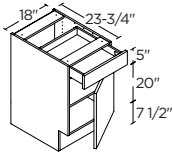

1 DOOR / 1 DRAWER
18" | B18ADA

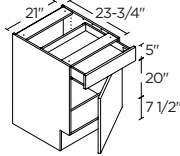

1 DOOR / 1 DRAWER
21" | B21ADA

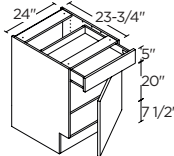

1 DOOR / 1 DRAWER
24" | B24ADA

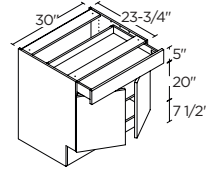

2 DOORS / 1 DRAWER
30" | B30ADA

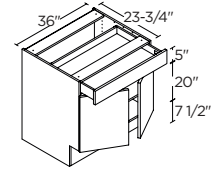

2 DOORS / 1 DRAWER
36" | B36ADA

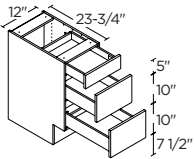

3 DRAWERS
12" | B3D12ADA

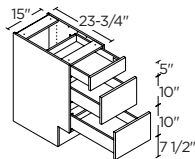

3 DRAWERS
15" | B3D15ADA

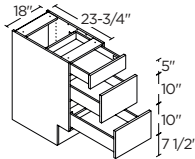

3 DRAWERS
18" | B3D18ADA

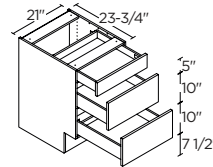

3 DRAWERS
21" | B3D21ADA

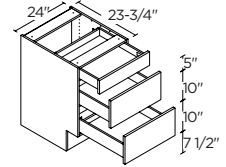

3 DRAWERS
24" | B3D24ADA

UNIVERSAL VANITY CABINETS *Produced with white interiors.*

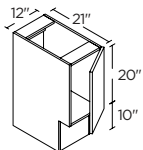

1 DOOR
12" | V12ADA(L/R)

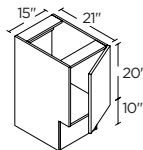

1 DOOR
15" | V15ADA(L/R)

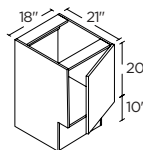

1 DOOR
18" | V18ADA(L/R)

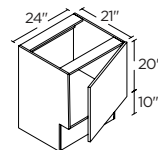

1 DOOR
24" | V24ADA(L/R)

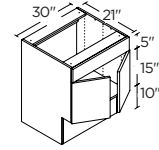

2 DOORS
30" | VS30ADA

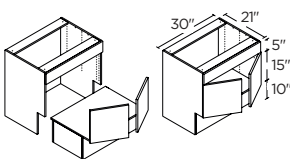

2 DOORS
30" | VS30FFRFADA

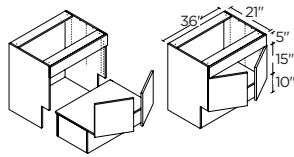

2 DOORS
36" | VS36FFRFADA

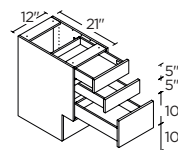

3 DRAWERS
12" | V3D12ADA

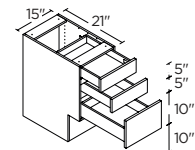

3 DRAWERS
15" | V3D15ADA

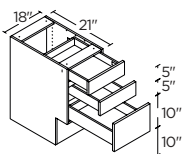

3 DRAWERS
18" | V3D18ADA

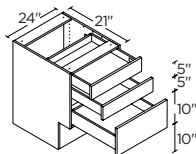

3 DRAWERS
24" | V3D24ADA

Use CP1496 as toe-kick

COLOR-MATCHED ACCESSORIES

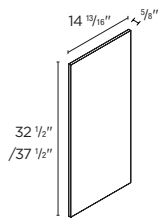

WALL CABINET COVER PANEL
14 13/16"
 5/8 x 32 1/2" | CP1432
 5/8 x 37 1/2" | CP1437

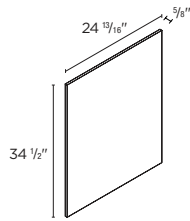

BASE CABINET COVER PANEL
24 13/16"
 5/8 x 34 1/2" | CP2434

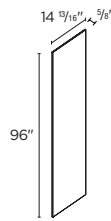

TALL CABINET COVER PANEL
14 13/16"
 5/8 x 96" | CP1496

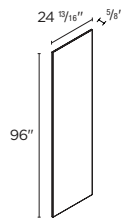

TALL CABINET COVER PANEL
24 13/16"
 5/8 x 96" | CP2496

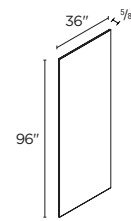

TALL CABINET & FRIDGE GABLE COVER PANEL 36"
 5/8 x 96" | CP3696

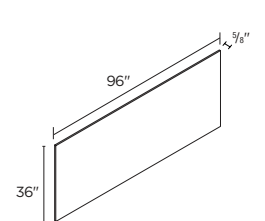

ISLAND PANEL 36"
 5/8 x 96" | CP3696

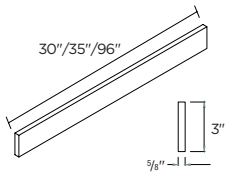

FILLER
 3 x 5/8 x 30" | F330
 3 x 5/8 x 35" | F335
 3 x 5/8 x 96" | F396

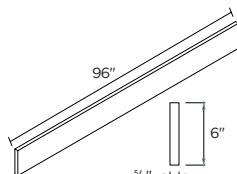

FILLER
 6 x 5/8 x 96" | F696

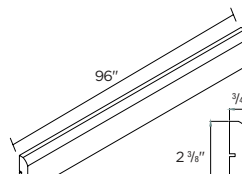

DECORATIVE MOULDING
 Available for Veneto & Barletta only
 96 x 2 3/8 x 3/4" | DMC2.596

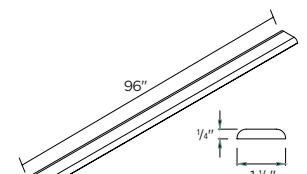

SCRIBE MOULDING
 Not available for Sassari
 96 x 1/4 x 1 1/4" | SBM96

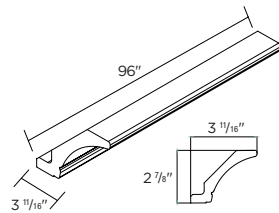

COVE CROWN MOULDING
 With integrated cleat
 Not available in Sassari
 96 x 3 1/16 x 2 7/8" | CCM96C

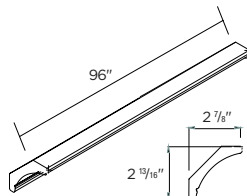

COVE CROWN MOULDING
 Without cleat
 Not available in Sassari
 96 x 2 13/16 x 2 7/8" | CCM96NC

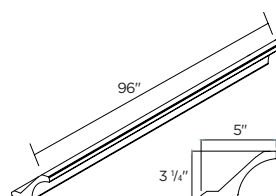

COVE PLAIN CROWN MOULDING
 With integrated cleat
 Available for Veneto & Barletta only
 96 x 5 x 3 1/4" | CCMP96C

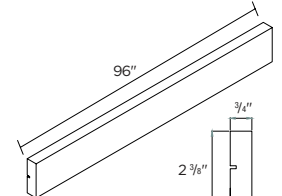

STRAIGHT LIGHT VALANCE MOULDING
 96 x 2 3/8 x 3/4" | SLV96

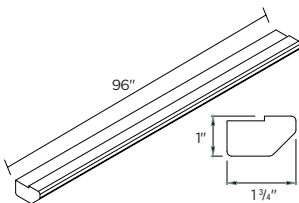

DECORATIVE LIGHT VALANCE MOULDING
 Not available for Sassari
 96 x 1 x 1 3/4" | DLV96

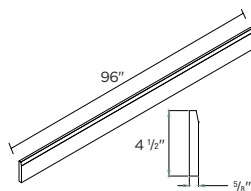

BASE MOULDING
 Not available in Sassari
 96 x 5/8 x 4 1/2" | BM96

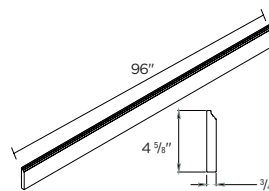

FURNITURE BASE MOULDING
 Available for Veneto & Barletta only
 96 x 3/4 x 4 5/8" | FBM96

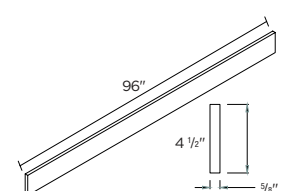

TOE-KICK
 96 x 5/8 x 4 1/2" | TK96

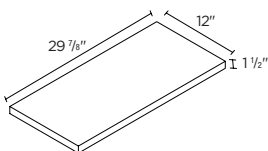

FLOATING SHELF
 30 x 12 x 1 1/2" | FS30

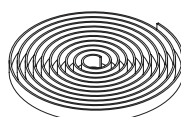

EDGE BANDING
 35' roll | ET35

COLOR-MATCHED ACCESSORIES

INTERIOR ACCESSORIES

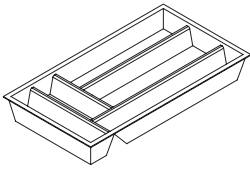

**CUTLERY TRAY FOR
15" DRAWER**
15 x 24" | CT15

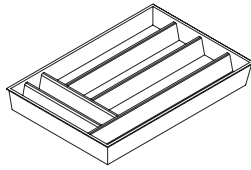

**CUTLERY TRAY FOR
18" DRAWER**
18 x 24" | CT18

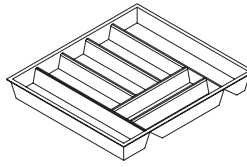

**CUTLERY TRAY FOR
24" DRAWER**
24 x 24" | CT24

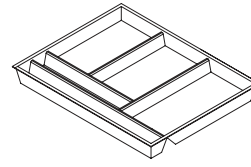

**CUTLERY TRAY FOR
30" DRAWER**
30 x 24" | CT30

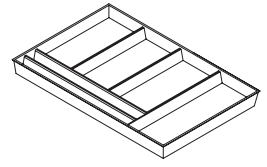

**CUTLERY TRAY FOR
36" DRAWER**
36 x 24" | CT36

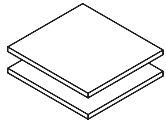

SHELVING FOR 14" DEEP CABINETS

Cabinet Widths:

9" | SHL-914
12" | SHL-1214
15" | SHL-1514
18" | SHL-1814
21" | SHL-2114
24" | SHL-2414
27" | SHL-2714
30" | SHL-3014
33" | SHL-3314
36" | SHL-3614

All shelving is 3/4 thick

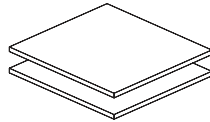

SHELVING FOR 24" DEEP CABINETS

Cabinet Widths:

9" | SHL-924
12" | SHL-1224
15" | SHL-1524
18" | SHL-1824
21" | SHL-2124
24" | SHL-2424
27" | SHL-2724
30" | SHL-3024
33" | SHL-3324
36" | SHL-3624

All shelving is 3/4 thick

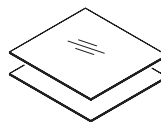

**GLASS SHELVING FOR
14" DEEP CABINETS**

15 x 1/4" | GSHL-1514
18 x 1/4" | GSHL-1814
30 x 1/4" | GSHL-3014
36 x 1/4" | GSHL-3614

*All shelving is 1/4" thick
tempered glass*

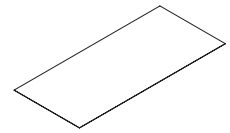

DRAWER MAT

Must be trimmed by installer
46 x 24" | DM46

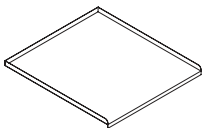

UNDER SINK MAT

30 x 24" | SBM30
36 x 24" | SBM36

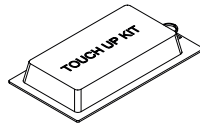

TOUCH-UP KIT (TUK)

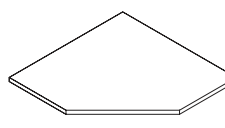

**SHELF FOR WALL DIAGONAL
CORNER CABINET**

24" | SHL-2424 CORNER

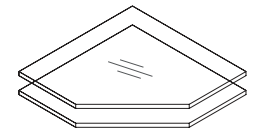

**GLASS SHELF FOR
WALL DIAGONAL
CORNER CABINET**

24" | GSHL-2424C
CORNER - PACK OF 2

*All shelving is 1/4" thick
tempered glass*

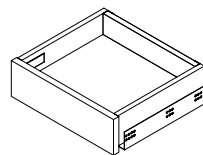

**INNER DRAWER KIT FOR
14" DEEP CABINETS**

15 x 3 3/8" | DK1514
18 x 3 3/8" | DK1814
24 x 3 3/8" | DK2414

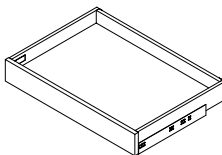

**INNER DRAWER KIT FOR
24" DEEP CABINETS**

12 x 3 3/8" | DK1224
15 x 3 3/8" | DK1524
18 x 3 3/8" | DK1824
21 x 3 3/8" | DK2124
24 x 3 3/8" | DK2424
27 x 3 3/8" | DK2724
30 x 3 3/8" | DK3024
33 x 3 3/8" | DK3324
36 x 3 3/8" | DK3624

Used to connect BC36 door sets together

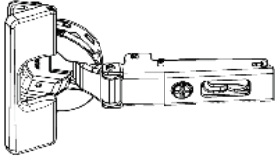

110 DEGREE HINGE

Used for standard doors
HIN110

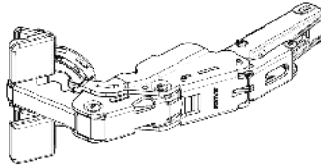

155 DEGREE HINGE

Must be used when adding interior drawers behind cabinet doors
HIN155

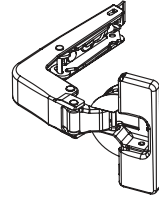

110 DEGREE BLIND CORNER HINGE

HINBC

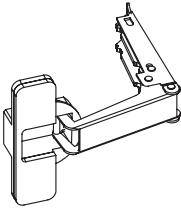

PIE CUT HINGE

Used to connect BC36 door sets together
HINPC

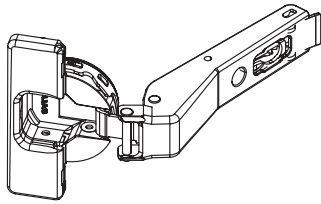

DIAGONAL CORNER WALL HINGE

HIN45

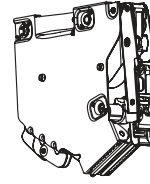

HORIZONTAL LIFT-UP HINGE

Used to create lift-up doors
HINLU



Amalfi and Palermo

CREATE A UNIQUE AND CUSTOM DESIGN

Combining door styles adds a dynamic and upscale look to every space. Not only does this give an exquisite visual appeal, but it opens your décor color palette to lead you to endless possibilities. Be bold, creative, and have fun creating your own personal style!

A large grid of dashed lines covering the majority of the page, intended for taking notes or drawing.



Cassarya

C A B I N E T R Y

T: +1-877-726-7272
E: INFO@CASSARYA.COM
W: CASSARYA.COM